

Firehood Installation Guide

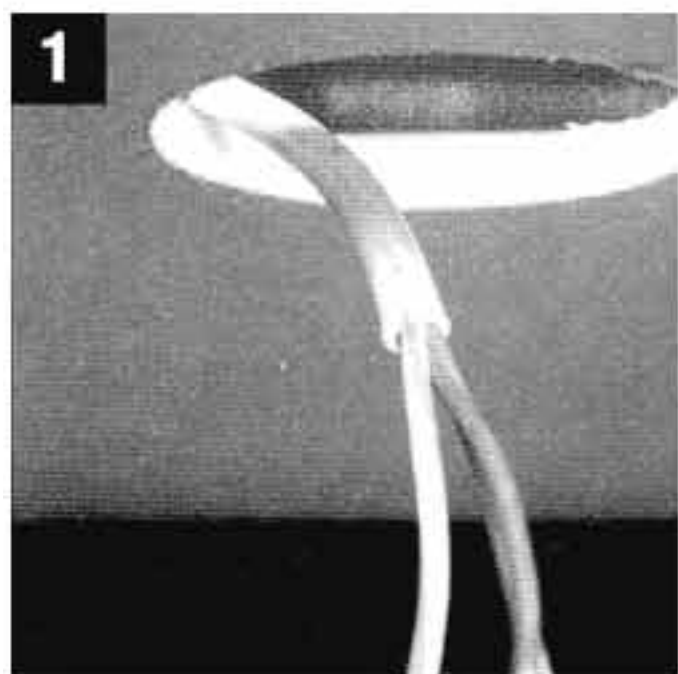

Lead the cable from the transformer through the hole cut for the downlighter fitting

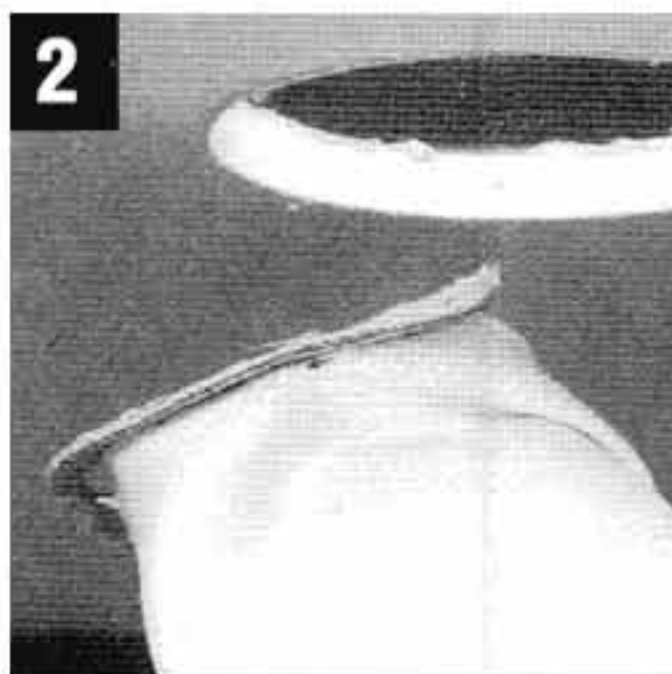

Squeeze the cover to reduce its size and slot it through the hole (retaining a grip on the clips throughout the process)

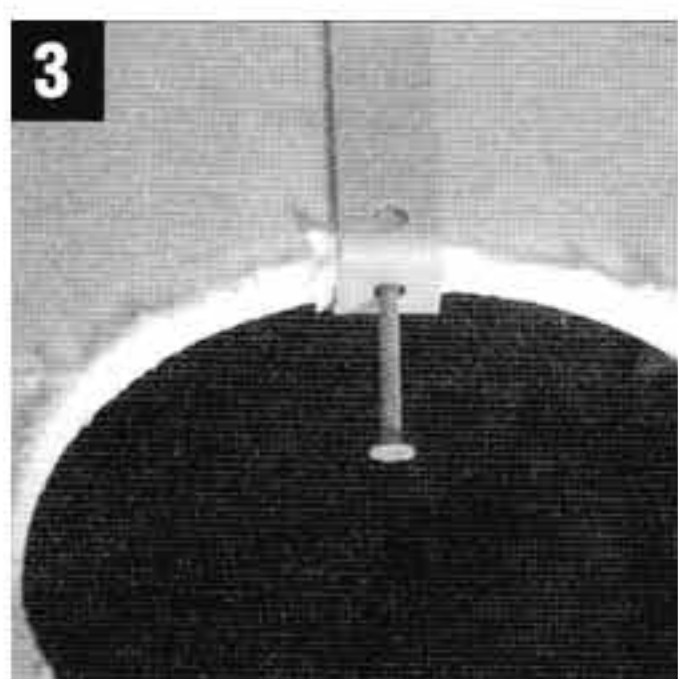

This clip is used to attach the firehood to the ceiling

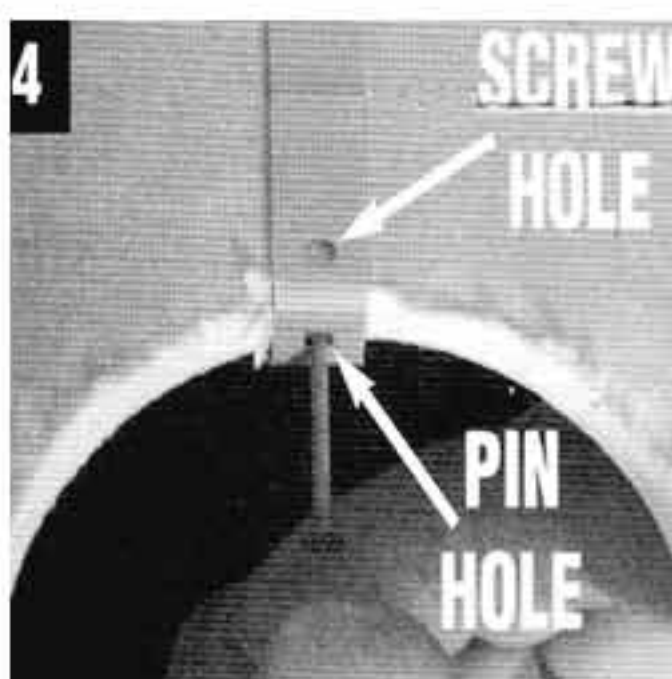

Whilst holding the clip align the pin hole to the ceiling and pin the two together using a supplied fixing pin

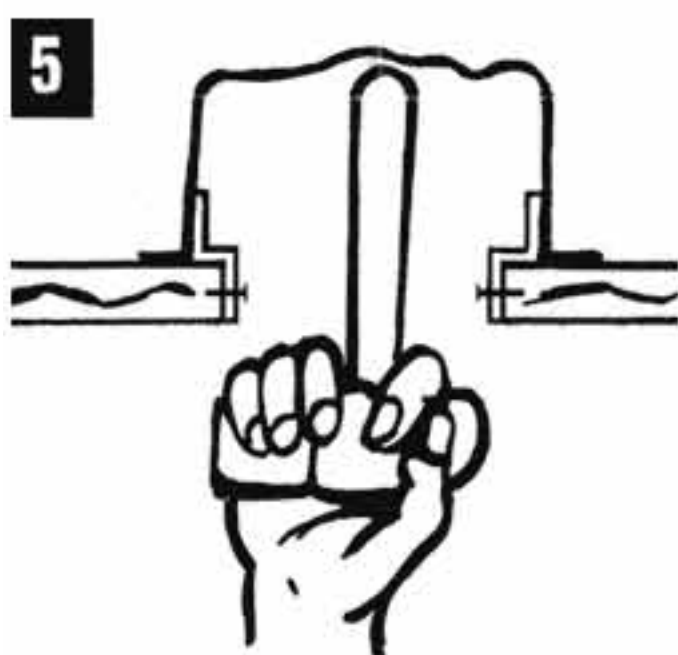

Push the firehood as far as possible into the hole using a blunt object so it is fully open in all directions

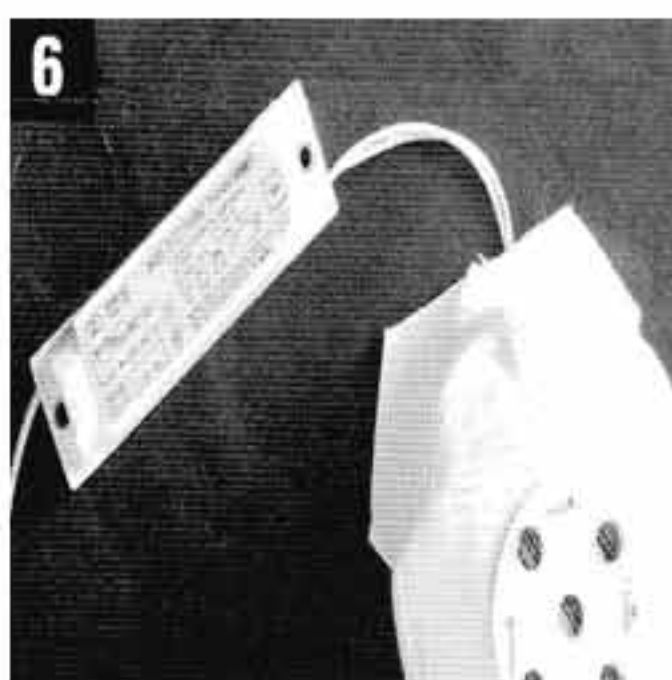

This is the finished installation ready for the downlighter to be installed in the ceiling

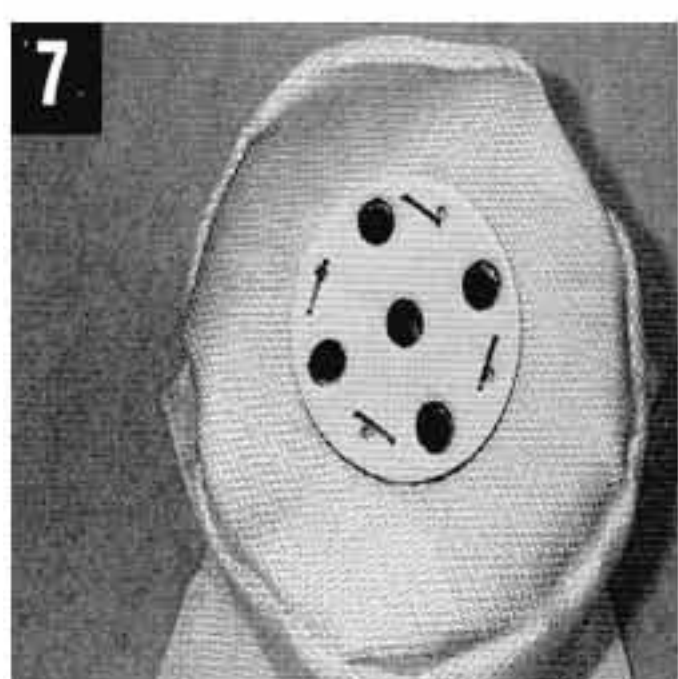

The fixing clips should be positioned at the edge of the ceiling aperture and once pinned in place the firehood may be opened out

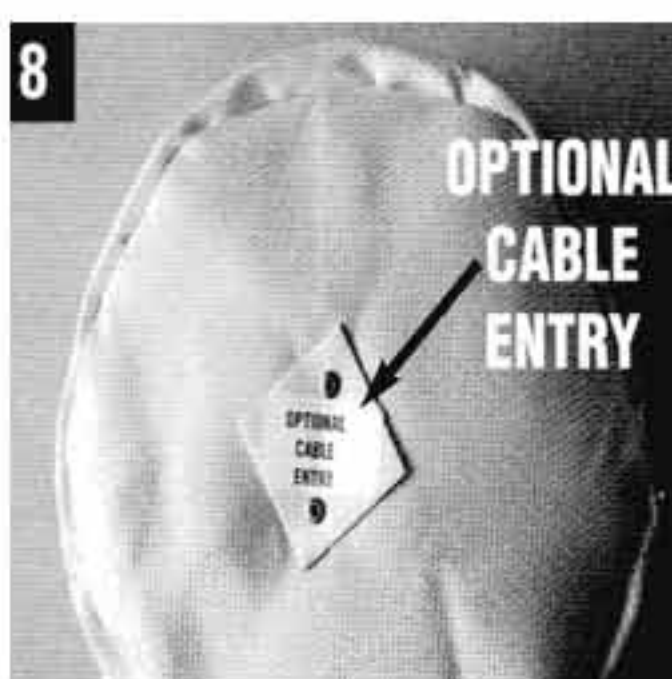

On acoustic firehoods there is an optional cable entry on the top, normal cable entry is from the bottom of the firehood

